



1500 Frost Rd. | P.O. Box 2068 | Streetsboro, Ohio 44241 330.626.2801 | support@permco.com

DMD25/DM640

Common Installation Instructions

Product designed for dump body applications only.

1. The vehicle must be securely "locked out" before any work is performed on the hydraulic circuit. Never work on a raised dump bed without proper body props and supports.
2. Follow PTO/Truck Chassis Manufacturers Guidelines for PTO connection(s) to ECMs/TCMs to control operating parameters.
3. Prior to PTO engagement, ensure the Dump Pump has unobstructed oil supply!
4. PTO should be properly disengaged PRIOR to lowering the bed and before vehicle movement.

Standard Offering Plumbing Instructions

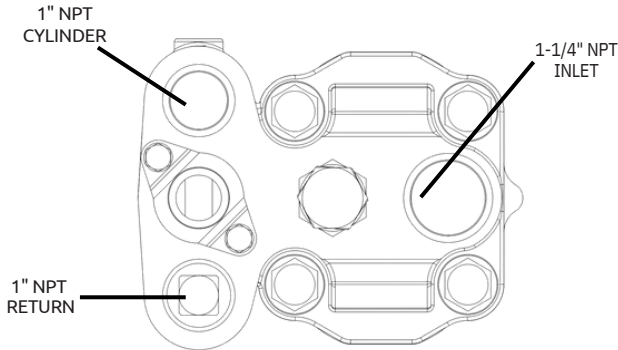

1" NPT fitting torque not to exceed 130 ft. lbs.
1-1/4" NPT fitting torque not to exceed 160 ft. lbs.

Loctite Primer 7649 and Loctite Sealant 567 is recommended for thread sealant. Do not use Teflon Tape as a thread sealant. The use of Teflon Tape will void all warranties expressed or implied for this product.

Always use a minimum 1-1/4" suction hose (SAE-100R4) on pump inlet.

3-LINE PLUMBING -- Install 3 line sleeve in the 1-1/4 " inlet port. Install 1" (minimum) return line to reservoir. For longer pump life and better performance, three line plumbing is highly recommended!

2-LINE PLUMBING -- Return port plugged and NO sleeve in installed. Using two line plumbing can result in catastrophic pump failure if not operated correctly!

The relief valve setting should be verified before the equipment is put into service. Dump Pump relief valves are available in 2000 or 2500 PSI (+/- 5%) Not to exceed 2500 PSI.

MOUNTING INSTRUCTIONS – DIRECT MOUNT

(EXAMPLES ONLY) FOR BRACKET CONSTRUCTION

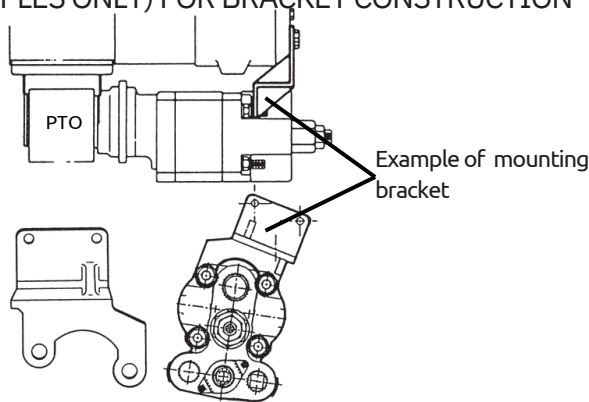

Direct mount Dump Pump comes standard with SAE 4 bolt B mount, 7/8" 13 T spline and two extended studs for mounting support bracket.

Consult PTO Owners Manual for pump mounting recommendations. 4 point support contact required: 2 on the pump, 2 to the transmission.

If factory extended studs are relocated, re-torque to 200 ft lbs.

Apply anti-seize grease to PTO shaft before mounting Dump Pump. Re-apply annually or sooner for severe duty applications.

MOUNTING INSTRUCTIONS – REMOTE MOUNT VERSION

Consult Driveline Manufacturer for proper shaft sizing and "Working Angles" for remote mounted Dump Pump.

Twin shafted remote mount pumps require optional pump bracket.

Remove nuts and spacers. Slide bracket over bolts, replace washers and tighten nuts. This procedure does not open the pump.

CONVERSION SLEEVE INSTALLATION

For 3-Line plumbing (only):

- install sleeve in inlet port
- remove plug from pump return port
- install minimum 1" return line hose to reservoir

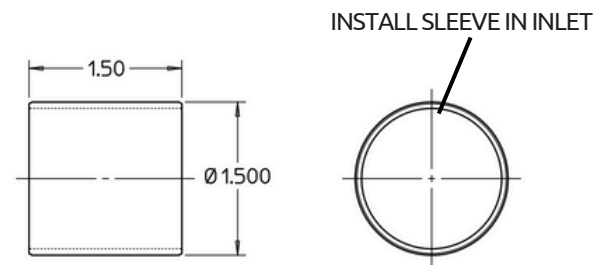
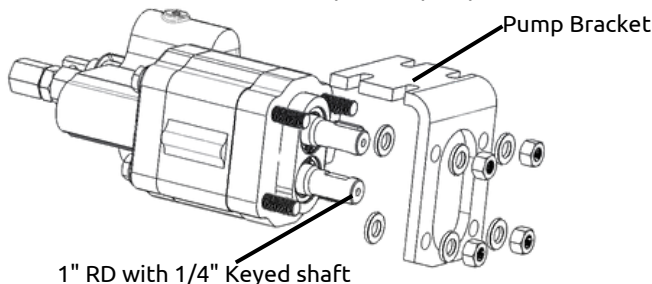

Bulletin_124-1_DPINSTALL

NOTE: When replacing an existing pump, always filter or replace hydraulic fluid to remove contaminants.

COMMON CHASSIS MOUNT & TRAILER MEDIUM/HEAVY DUTY DUMP PUMP PLUMBING

3 Line Wet Kit for Dump Application

(Allows for oil recirculation to reservoir.)

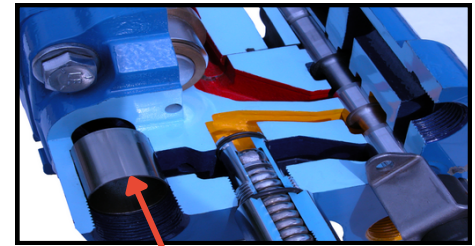
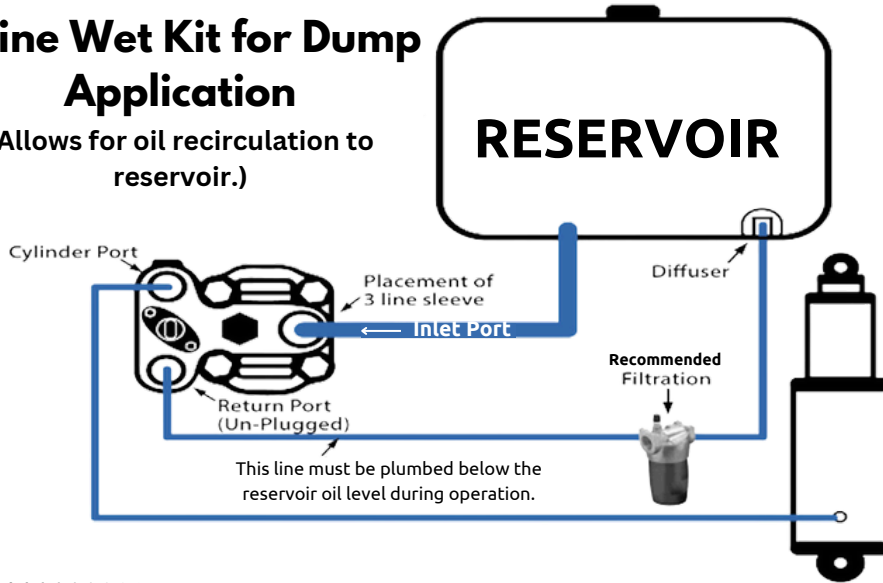

CUT AWAY showing 3-Line Sleeve installed

2 Line Wet Kit for Dump Application

(Does not allow for oil recirculation to reservoir.)

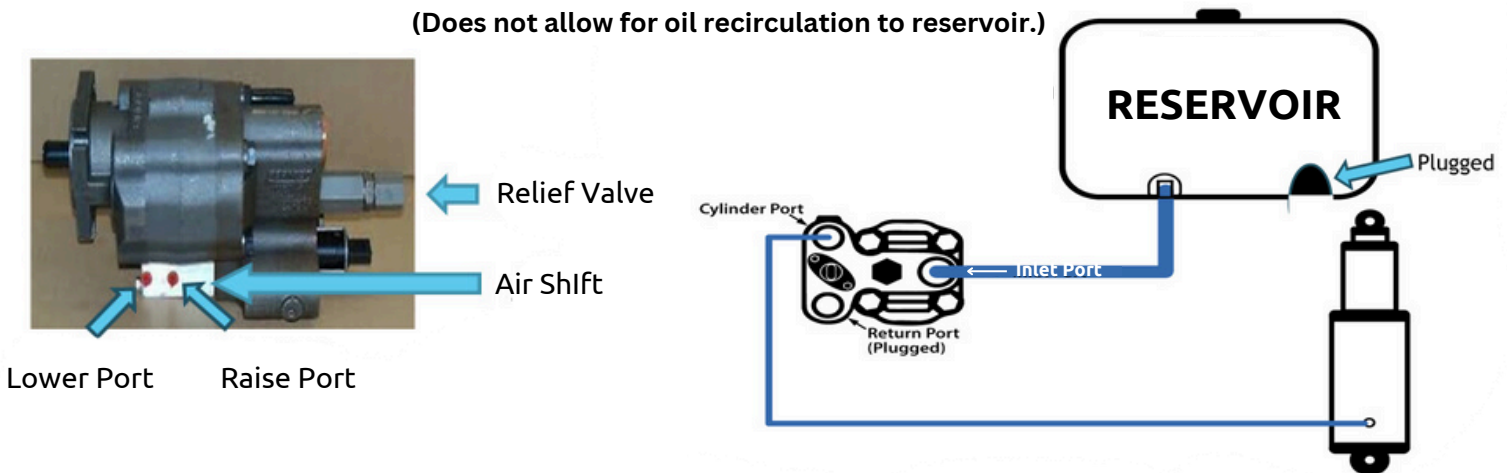

Installation Review & Recommendations

1. Use 1-1/4" suction rated hose (minimum). Incorrect hose and/or size will cause cavitation and Dump Pump failure. Heavy Duty T-bolt hose clamps or crimped hose ends are recommended.
2. Caution, do not over-tighten NPT fitting. See maximum torque values shown above.
3. Do not install 3-Line Sleeve on 2-Line systems!
4. Caution: Incorrect Return Line Size or restrictions of flow to Reservoir can cause Dump Body to rise unexpectedly.
5. All fluid connections on the Reservoir must be below the minimum fluid level with the cylinder fully extended.
6. A return line diffuser is required if the Reservoir does not have an internal baffle.
7. When a top Reservoir return port is used, a long drop tube should be installed and located on the opposite side of suction port.
8. Oil should NOT exceed an ISO 4406 cleanliness level of 19/17/14
9. After installation, verify there are no leaks, and the reservoir has the correct fluid level.

Caution: Disengage PTO before vehicle movement.