

# 2-Position 3-Way Hydraulic Selector Valve

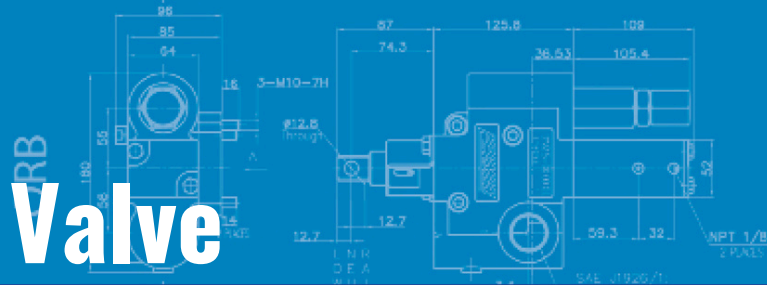

Precision-Engineered Fluid Power Products

Permco's 2 position Hydraulic Selector valve is designed for directing flow from a single pump flow to two separate individual hydraulic work circuits.

Flow enters the valve through inlet port and the spool diverts flow to two independent flow directions.

Pneumatic shifted model uses one Air Line, connected to rear of the shifter. Supplied Vent is installed in the other port.

## Features

- 60 gallons of flow capability
- Up to 3600 PSI working pressures
- 1" SAE/ORB ports on Inlet and Outlet ports
- Oversized spool and internal flow cavity
- Pneumatic version comes with enclosed spool ends to reduce corrosion
- Allows Pump Flow to be directed to 2 independent circuits

## Pneumatic shifted



PN 514-01931-A

## Manual shifted



PN 514-01931-M



**Pneumatic** shifted model uses one Air Line connection that when activated, moves the spool & flow from “A” to “B” Port

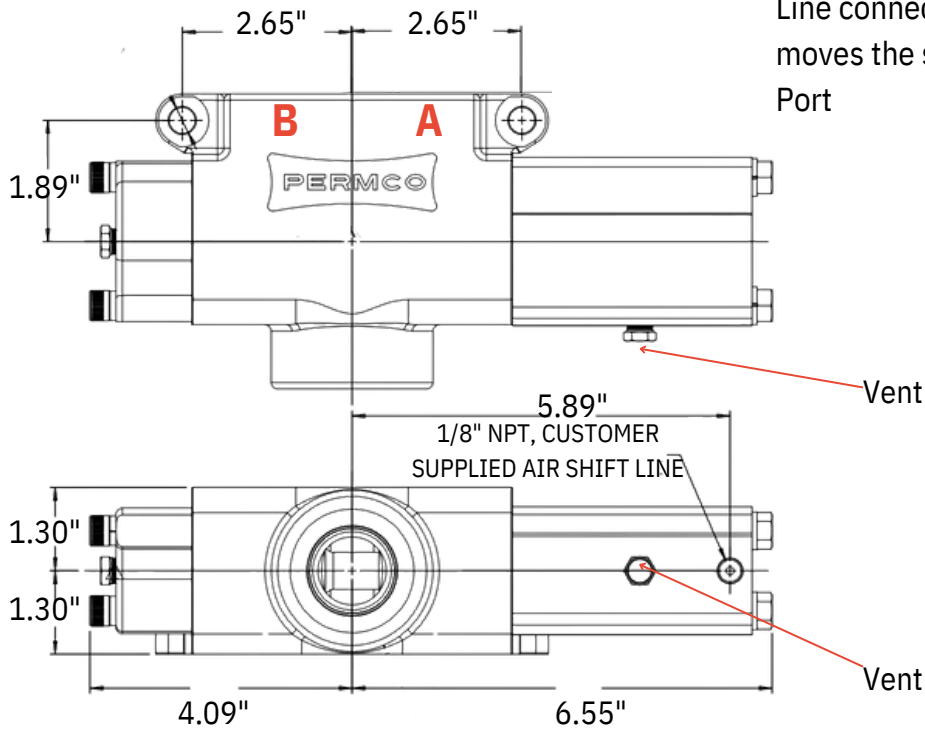

**Manual** shifted model with knob pulled out activates “A” Port. Knob pushed in activates “B” Port.

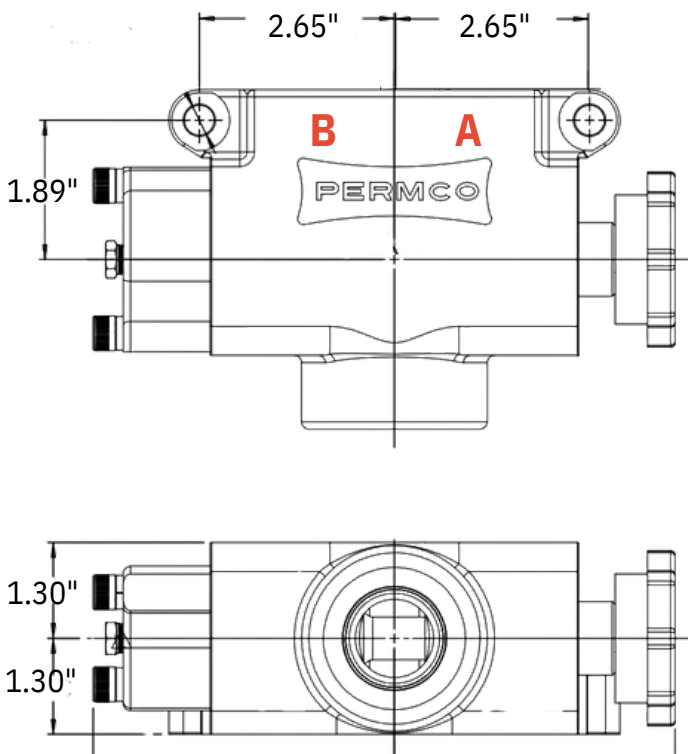

Our Online Support is available  
24/7/365 for your needs!  
Email: [support@permco.com](mailto:support@permco.com)  
Call: (800) 626.2801



[www.permco.com](http://www.permco.com)



Bulletin\_726-1\_SELVAL